

Trajectory Productions Inc.

Mailing Address:
P.O. Box 338, North Windham, CT 06256
Telephone: 860.377.1912

Michelle Berting Brett

in

We've Only Just Begun: Carpenters Remembered

FULL RIDER 2022

(Updated June, 2022)

5-Piece Band – Michelle + 4 musicians + Mark (Producer) = 6 traveling

This Rider ("Rider") is attached to and made a part of the contract (the "Contract") between TRAJECTORY PRODUCTIONS INC. ("Producer") furnishing the services of **Michelle Berting Brett in *We've Only Just Begun: Carpenters Remembered*** ("Artist") and the purchaser of said services ("Purchaser") as defined on the face of the Contract in connection with Artist's performance(s) at the venue(s) described therein (the "Venue" or the "Engagement").

(This Rider may not be altered or amended in any way without the express written consent of Mark Brett or Michelle Berting Brett of Trajectory Productions Inc.)

Contacts:

- (Producer/Production Manager) Mark Brett – 860.377.1912
markbrett1912@gmail.com
- (Producer/Star) Michelle Berting Brett – 860.942.2280
michelle_berting@hotmail.com

PRESENTER, PLEASE PROVIDE THE FOLLOWING INFORMATION:

Venue: Technical Director/Production Manager

Name: _____

Phone: _____ FAX: _____

Email: _____

Michelle Berting Brett in *We've Only Just Begun: Carpenters Remembered*
2022 HOSPITALITY RIDER (5-PIECE BAND)

Producer & Production/Tour Manager:

Mark Brett (Advance contact) – 860.377.1912 – markbrett1912@gmail.com

1. Advertising & Promotion:

- a. *PURCHASER* understands that the name of this event is **Michelle Berting Brett in *We've Only Just Begun: Carpenters Remembered*** and must be billed and advertised as such, as specified in the Engagement Agreement.
- b. Alternately may be advertised as ***We've Only Just Begun: Carpenters Remembered* starring Michelle Berting Brett.**
- c. Only materials provided by Trajectory Productions Inc. will be permitted for advertising this event. **No internet downloads permitted.**
- d. Show poster and promotional photographs provided by Trajectory Productions Inc. shall be used in print, online, and in-house promotional material.
- e. Video and audio clips provided by Trajectory Productions Inc. will be used in any online, television, and radio advertising.

2. Hotel:

- a. FIVE (5) King rooms, for each performance night and one travel night as needed. (Holiday Inn or better with complimentary WIFI Internet service and continental breakfast).
- b. Rooming List to be provided by Trajectory Productions Inc.

3. Hospitality (Food/Beverage):

- a. Dressing Room: Fruit tray, veggie tray, meat & cheese tray, assorted chips, breads, water, coffee & tea, and soda (regular & diet).
- b. Catering: Hot meal or buffet for SIX (6), or \$25.00 per person meal buyout between sound check and show time. Buyout should be given IN CASH to Production Manager upon arrival for sound check. (\$150 in \$20 & \$5 bills.)

4. Transportation:

- a. Fly Dates: Transportation between airport/hotel/venue will be required for SIX (6) people plus luggage and instruments.
- b. In some cases, the band will be arriving from different parts of the country. Every effort will be made to have all arrive at the same general time in order that only one airport run may be required. Proper notice will be given if more than one run will be required.
- c. Drive Dates: Parking for several small vehicles or ONE (1) tour bus will be required as close to stage door as possible for load-in, load-out, and show. Vehicle type(s) and numbers to be advanced.

5. Dressing Rooms:

- a. At least TWO (2) dressing rooms will be required. Please have iron, ironing board, and steamer available.

6. Deposit & Final Payment:

- a. **Deposits:** All deposits are due a minimum of SIXTY (60) days prior to performance date and payable to *Mark Brett/Trajectory Productions Inc. (EIN: 83-0920389)*
- b. **Final Payments:** Final payment is *due at sound check day of show*. Any overages or percentages due to Artist will be paid immediately following performance via Cash, Casino Check, or Money Order payable to *Mark Brett/Trajectory Productions Inc. – (EIN: 83-0920389)*.
No personal checks will be accepted.

Purchaser Signature

Date

Michelle Berting Brett in *We've Only Just Begun: Carpenters Remembered*
2022 TECHNICAL RIDER (5-PIECE BAND)

1. **Sound:** In the event that the PURCHASER / PRESENTER'S facility does not conform to the ARTIST'S minimal technical requirements, as outlined below, additional personnel and/or production may be required and is the sole responsibility of the PURCHASER / PRESENTER. If the facility does not conform to the show's minimum requirements, please notify the Tour Manager immediately. Please have all sound equipment including the house sound system and accessories (sound boards, microphones, speakers, cables, monitors, etc.) and all backline instruments and amplifiers present and fully operational no later than 5 hours before the scheduled event start time. ARTIST will arrive approx 5 hours before show time.
2. **Personnel:** PURCHASER shall provide and pay for the following personnel:
 - a. Front of house engineer with full working knowledge of system.
 - b. Monitor engineer with full working knowledge of monitor system.
 - c. Video system operator with full working knowledge of video system.
 - d. Light Designer with full working knowledge of light system.
 - e. Backline tech with full working knowledge of all backline.
 - f. TWO (2) Spot operators.
3. **Front of House:** ARTIST does not travel with an FOH engineer so the FOH console is ultimately the vendor's choice. PURCHASER must supply a professional 3 or 4 way sound system capable of producing a 20 Hz to 20 kHz frequency range at 100 db SPL on the back row of the venue. Line array system is preferred. Acceptable brands are JBL, EV, Meyer Sound or Claire Brothers. Front fill should be provided along the down stage lip. In venues where there is a balcony, consideration must be given to ensure full and even coverage to all balcony seats. Digital consoles are REQUIRED for both Front of House and Monitors. Preferred digital mixing consoles (FOH & Monitor) are: Yamaha M7CL, or Digidesign Venue series. These consoles are for the sole use of **Michelle Berting Brett in *We've Only Just Begun: Carpenters Remembered***. Digital console software should be completely up to date and contain all required eq's, FX, compressors and gates.
4. **Wireless (RF) Channels:** PURCHASER to provide ONE (1) handheld wireless microphone (Shure UR4D+ series) and ONE (1) UR2 series transmitter with STANDARD SM-58 capsule required. Mic should be tested and in excellent working condition before ARTIST arrival. Batteries should be changed between sound check and show time.

5. **Monitors:** ARTIST does not travel with a monitor engineer so the monitor console is ultimately the vendor's choice. Digital console (as above) is required. Monitor world should be stage left where possible. FIVE (5) separate monitor mixes will be required as per stage plot. Wedge show.
6. **Lighting:** PURCHASER shall provide a lighting designer (LD) who will be available at sound check until the conclusion of the event.
 - a. PURCHASER shall provide a minimum of two (2) spotlights and two spot light operators.
 - b. PURCHASER shall provide appropriate SHOW lighting (minimum of 48 cans) with assorted colored gels of reds, blues, ambers and whites. Each color should wash entire performance area.
7. **Risers:** ONE (1) riser will be required (see stage plot) for drummer.
8. **Video:** Purchaser to provide video play back system to accommodate show multi-media. System to include:
 - a. Video system operator who will be available at sound check until the conclusion of the event.
 - b. 9'x12' Video screen (Minimum) mounted center stage above drum riser. Screen must be easily visible from all house seats. Can be front or rear projector.
 - c. Minimum 5000 lumen projector. Focused on the screen.
 - d. House video computer for video playback.

Purchaser Signature

Date

**Michelle Berting Brett in *We've Only Just Begun: Carpenters Remembered*
BACKLINE 2022 (5-PIECE BAND)**

We request the opportunity to communicate directly with the Backline company once the Buyer/Promoter has confirmed the vendor. We will be able to work with them in the event of any substitutions, etc.

PURCHASER TO PROVIDE AND PAY FOR THE FOLLOWING BACKLINE:

DRUMS

Pearl or Yamaha, 5-piece Drum Kit
(kick, snare, 2 rack toms, 1 floor tom with legs)
16 x 22 kick with double tom mounting bracket
16 x 16 floor tom with legs
10 x 12 rack tom mountable on kick
10 x 10 rack tom mountable on kick
1 - 5.5 x 14 metal snare & (1) 5.5 x14 wood snare
2 - single kick pedals (Pearl or Yamaha)
3 - cymbal stands
1 - hi hat stand
1 - saddle throne
1 - DRUM SHIELD!! (5 to 6 panels)
Zildjian Cymbals preferred (Sabian & Paiste OK too.)
20" K Custom Hybrid or A Custom Ride
19 " K Custom Hybrid Crash or A Custom Crash
17 " K Custom Hybrid Crash or A Custom Crash
14" New Beat Hi Hats, or 14" K Custom Hybrid, or 14" A Custom
New Remo Coated Ambassador heads – 1 ply, Spare Snare
1 - Music stand with light

BASS / BGV 4

First Choice: Ampeg SVT – Tube Amp (8x10 cabinet or 6x10 or 4x10)
Second Choice: Gallien-Krueger - 800RB Amp (4x10 or larger cabinet by any of the following: Ampeg, SWR, Aguilar, Eden, or GK)

1 - 10' Guitar Cable
1 - Music stand with light
1 - Guitar stand

RIDER – Michelle Berting Brett in *We've Only Just Begun: Carpenters Remembered*
CONTACT: Mark Brett, Producer 860-377-1912 markbrett1912@gmail.com

GUITAR / BGV 3**AMP**

First Choice: Fender Deluxe Reverb – or comparable.

Second Choice: VOX AC30 – or comparable.

1- 25'-30' Extra Long Guitar Cable

1- Music stand with light

1- Guitar stand

KEYS / BGV 1 & 2**Scenario #1**

Grand Piano – Tuned day of show (Piano must have internal music stand)

Keyboard:

1st Choice: Nord Stage – 88 Keys

2nd Choice: Yamaha Montage 8 – 88 Keys

1 – X-Stand

1 – Sustain pedal

1 – Piano Bench

1 – Drum Throne - Adjustable

1 – Music stand with light

OR**Scenario #2**

If no Grand Piano just one keyboard required:

1st Choice: Nord Stage – 88 Keys

2nd Choice: Yamaha Montage 8 – 88 Keys

Grand Piano Shell (Discuss at time of advance.)

1 – X-stand (If no piano shell available.)

1 – Sustain pedal

1 – Drum Throne – Adjustable

1 – Music stand with light

STAR VOCAL

2 – Standard size, sturdy bar stools (no back)

RIDER – Michelle Berting Brett in *We've Only Just Begun: Carpenters Remembered*

CONTACT: Mark Brett, Producer 860-377-1912 markbrett1912@gmail.com

(ALL BACKLINE SHOULD BE PLACED, POWERED AND READY 30 MINUTES PRIOR TO ARTISTS' ARRIVAL).

Purchaser Signature

Date

- *Please note: One Mic stand (no clip) for Drummer position mixer (Band supplies mixer)*

*** A Copy of This Stage Plot Must Present Day of Show ***

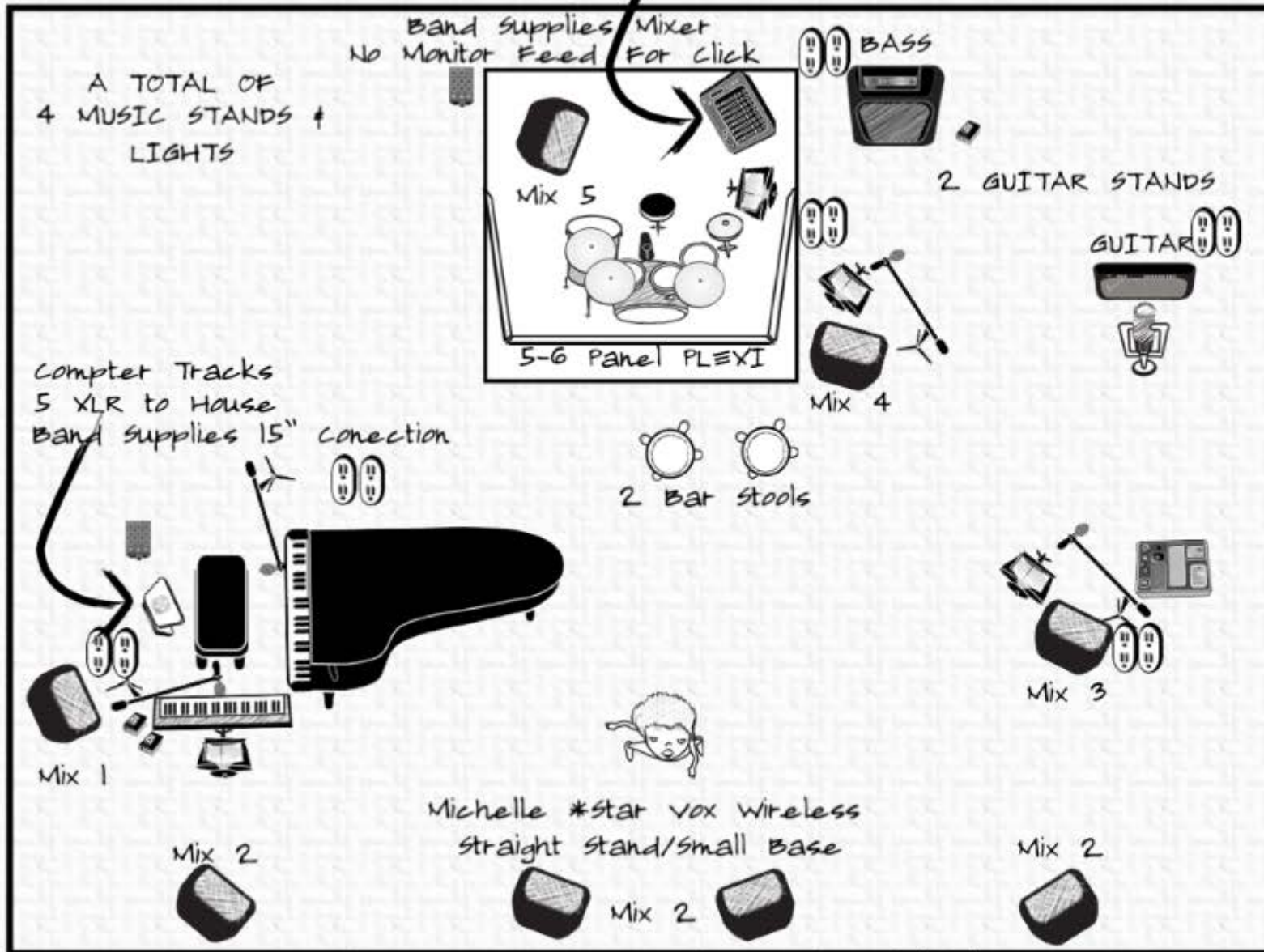

WOJB Carpenters Remembered 5pc 2φ2φ
Starring: MICHELLE Betting BRETT / TRAJECTORY PRODUCTIONS

sketch NOTES

WOJB CARPENTERS REMEMBERED 5pc
Starring: MICHELLE BETTING BRETT

1. Kick Beta-52
2. Snare SM-57
3. Hat SM-81
4. Tom 1 SM-98
5. Tom 2 SM-98
6. Floor SM-98
7. OHL SM-81
8. OHR SM-81
9. Bass DI
10. Piano SR-L (TBA)
11. Piano SR-R (TBA)
12. Key SR-L DI
13. Key SR-R DI
14. Electric GTR e609
15. BGV Track L
16. BGV Track R
17. Orchestra Track L
18. Orchestra Track R
19. Misc. Percussion Track
20. BGV 1/Keys VOX SM-58 or RF-58
21. BGV 2/Keys VOX SM-58 or RF-58
22. BGV 3/Guitar VOX SM-58 or RF-58
23. BGV 4/Bass VOX SM-58 or RF-58
24. STAR VOX RF-58
25. STAR VOX B/U RF-58

~12ft FROM STAR VOX TO DRUM RISER.
~DRUM PLEXI/BAFFLE A MUST.
~1 MIC STAND NO-CLIP AT DRUM POSITION.
~2 BAR STOOLS/STANDARD SIZE.

ANY QUESTIONS PLEASE GIVE ME A CALL.

THANK YOU...Mark
Napkin sketch
www.napkinsketchapp.com



WOJB Carpenters Re...
5pc 86φ-377-1912
Mark Brett / Producer